

## Operating instruction e Cutter

### Machine Elements:

1. On/Off switch
2. Battery
3. Battery unlocking button
4. Grip
5. Footplate
6. Spirit Level
7. Hinge point
8. Transportation handle
9. Adjusting screw (depth)
10. Adjusting nut (depth)
11. Shell
12. Bolts
13. Stopping point

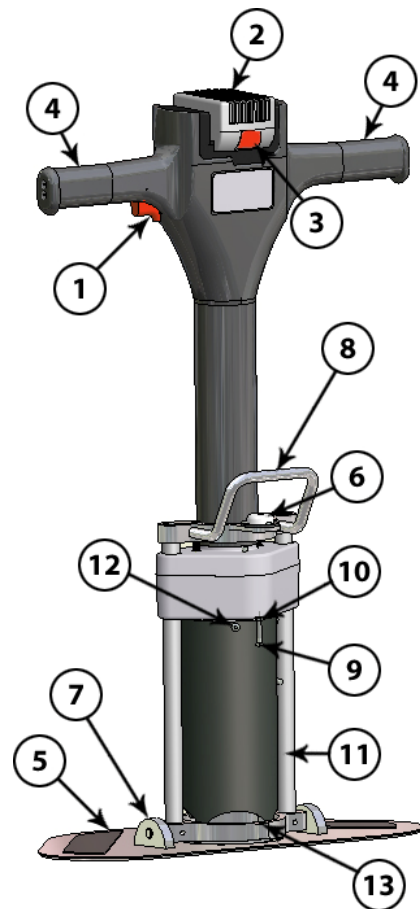

### Intended Use

The machine is intended for cutting holes in greens on golf courses.  
The holes have a diameter of max. 108 mm and a depth of max. 200 mm.

### For Your Safety

Safe usage of the machine presupposes that the instructions for use and safety are readied and are observed.

The machine and battery are to be checked before use. If there are any defects the machine should not be used. Repairs must be undertaken by a professional. Do not open the machine.

- When the machine is not in use (storing, repairing etc.) the battery is to be taken out. Not intended start by activating the On/Off switch can occur injuries.
- Control that the battery is in correct position before use.
- When using hold both hands on the grips and place the feet on the footplate.
- The machine must not be used by children.
- FSH machines a/s can only guarantee correct usage of eCutter when original spare parts/extra equipment are used.

## **Battery and Charger**

*Please read the enclosed manual for the battery and charger.*

- Protect the battery against moisture and water
- Store the battery only within a temperature range from 0°C and 45°C
- Clean the venting slots of the battery occasionally using a soft, clean and dry brush.
- Do not dispose of batteries into household waste, water or fire. Batteries must be disposed in an environmentally-friendly way. See environmental protection.

## **Before using the eCutter**

### **Charging the battery:**

To remove the battery (2), press the unlocking button (3) and pull out the battery horizontally. Do not exert any force.

The battery is equipped with an NTC temperature control which allows charging only within a temperature range of between 0°C and 45°C. Due to the intelligent charging method, the charging condition of the battery is automatically detected and the battery is charged with the optimum charging current, depending on battery temperature and voltage.

The charging procedure is indicated by flashing of the green charge control LED. Continuous lightning of the green charge control LED signals that the battery is fully charged.

### **Starting Operation**

Inserting the battery.

The battery is pushed horizontally into the battery slot by a light pressure. Do not activate the On/Off switch (1) at the same time.

### Start and stop

To start the machine, press the On/Off switch (1) and keep it depressed.

The machine runs with variable speed between 0 and maximum, depending on the pressure applied to the On/Off switch (1). Light pressure results in a low speed thus allowing smooth, controlled starts. Do not strain the machine so heavy that it comes to standstill.

To switch off the machine, release the On/Off switch.

### Operation Instructions

#### Cutting a hole with the eCutter.

1. Carry the machine onto the green by placing the battery at the hip and lifting the eCutter in the transportation handle (8).
2. Place the eCutter where the hole has to be cut and rotate the eCutter until the horizontal level (6) is in the correct position.
3. Place your feet on the footplate (5), pull the grip and adjust the vertical level to the correct position. Please note when standing on the footplate, it is only possible to adjust the shell (11) over the hinge points (7).

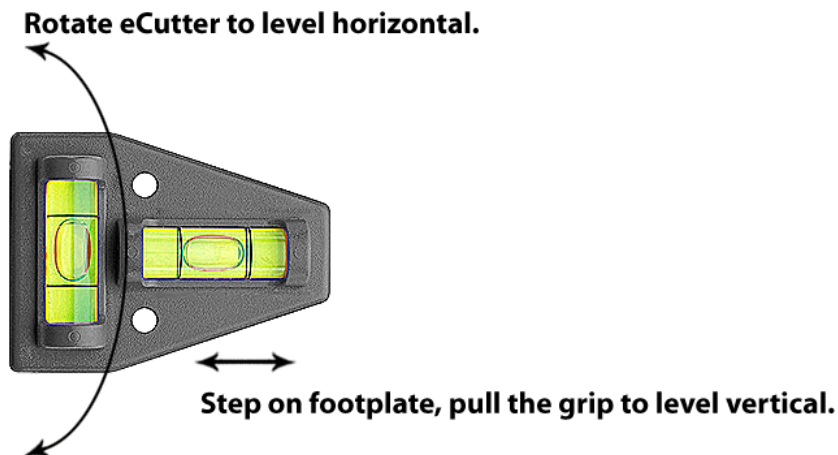

4. Hold the machine firm in the grips (4) and activate the On/Off switch (1). Put a gentle pressure on the grips (4) and let the shell (11) go down.
5. **IMPORTANT:** Observe the levels all the way to cut a perfect hole.
6. The hole is finished when the adjustment screw (9) reach the stopping point (13), and release the On/Off switch (1).
7. Remove your feet from the footplate (5) and lift carefully the eCutter up. **Please note:** To ensure that the plug of earth stays in the shell (11) pierce the plug with the vacuum spear to equalize the under pressure.

**Replacing the plug in the old hole.**

1. Take the eCutter to the old hole and place the shell (11) in the hole.
2. Place your feet on the footplate (5) and lift up the eCutter in the grips (4).  
**Please note:** Keep your back straight and use your legs to lift, and activate the On/Off switch (1) at the same time as lifting up in the grips (4).

On website: [www.fshmachines.com](http://www.fshmachines.com) a video demonstrates how to operate the eCutter.

**To ensure the best quality please keep the edges of the shell sharpened.**

**Which shell should be chosen:**

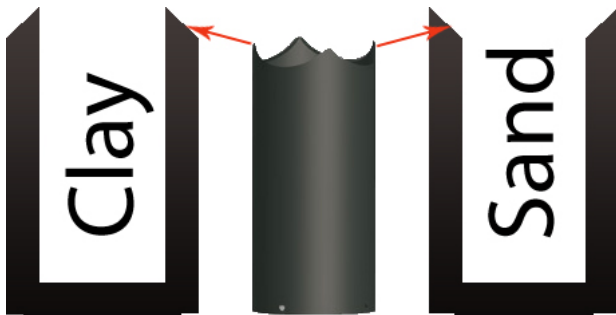

**Please note:** The above will work in most cases, but there may be some exceptions due to soil conditions where the opposite has to be chosen.

## Replacement of the shell

*The battery must be removed, before working on the machine.*

1. Place the machine on a vertical table.
2. Release the four bolts (12).
3. Pull the shell (11) in direction A – downwards out of the footplate (5).
4. The new shell is to be taken up through the footplate.
5. The four screws (12) are to be replaced through the holes in the shell (11) and tightened.

**IMPORTANT:** The long screws must be installed in the deep threads, The short screws must be installed in the short threads.

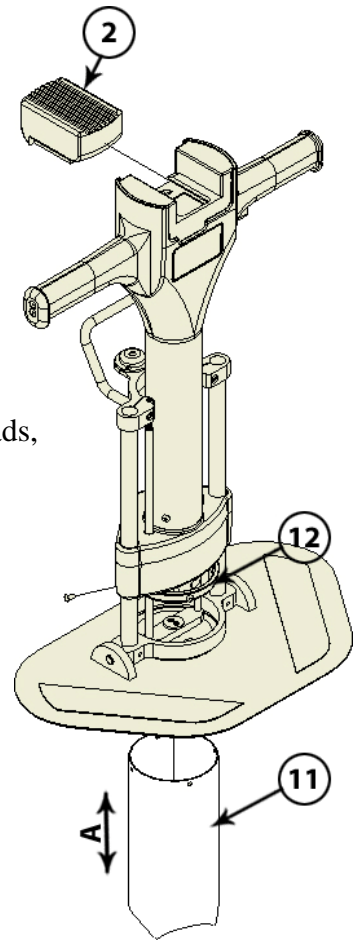
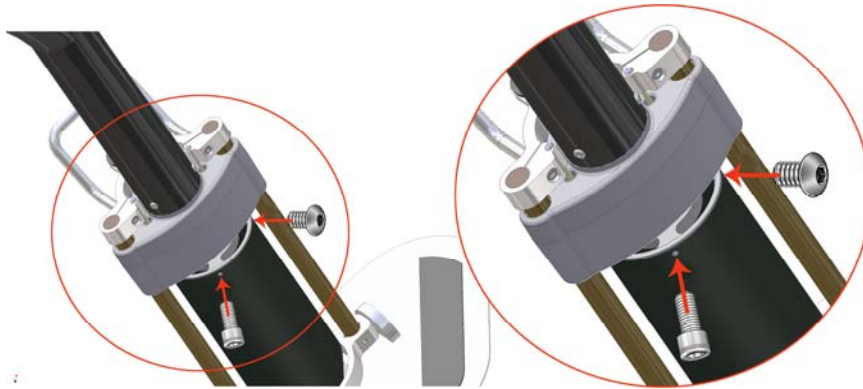

## Adjustment of the depth of a hole

*The battery must be removed, before working on the machine.*

Release nut (10) and adjust the adjustment screw (9) until the depth is correct. Tighten the nut (10) to fix adjustment screw (9) in its position.

## Cleaning

*The battery must be removed, before working on the machine.*

The machine must not be washed, with high pressure water.

## General Safety Rules and Instructions

### Rules from USGA and R&A.

The Royal and Ancient Golf of St Andrews (R&A)  
The United States Golf Association (USGA)

The hole has to be 4. inches (108 mm) in diameter and at least 4 inches (101,6 mm) deep. If a lining is used, it must be sunk at least 1 inch (25,4 mm) below the putting green surface.

### Instructions from USGA and R&A

The hole shall be cut vertical and not necessary perpendicular to the green surface.  
If the hole is cut on a slope, the gradient must not be so strong, that the ball increases its speed.  
In a radius of approximately one meter the green had to be as horizontal as possible.

### Troubleshooting:

Symptom	Solution
Motor will not run	<ol style="list-style-type: none"> <li>1. Recharge battery</li> <li>2. The allowable battery temperature of 70°C is exceeded; the electronic control switches off the eCutter until the temperature is in the optimum range again.</li> </ol>
Plug stay inside shell	Use vacuum spear
Hard to cut all the way down	Use outside sharpened shell
Plug will not stay inside shell	Use inside sharpened shell
Plug is to high after replacing it	<ol style="list-style-type: none"> <li>1. Do not start motor when ejecting plug</li> <li>2. Use outside sharpened shell</li> <li>3. Use lower speed when the hole is cut</li> </ol>
Hard to pull eCutter up from the ground	Observe the levels all the way up
Uneven depth of holes	Rotate eCutter 360° before pulling it up.
eCutter is spinning around when cutting	Drill a hole in the upper corner of the footplate and insert vacuum spear when cutting holes.
eCutter is losing power	<ol style="list-style-type: none"> <li>1. Battery is empty</li> <li>2. Protection against overloading is enabled. Shake eCutter and try again.</li> </ol>

### **Protection of the environment**

Batteries must not be disposed into household waste, water or fire.  
Batteries must be collected, recycled or disposed of in an environmentally-friendly way.  
Power tools, accessories and packaging should be sorted for environmental-friendly recycling.

### **Only for EC countries:**

Do not dispose of power tools into household waste! According to the European Directive 2002/96/EC on waste electrical and electronic equipment and its incorporation into national law, power tools that are no longer suitable for use must be separately collected and sent for recovery in an environmental-friendly manner.

### **Service and customer Assistance**

FSH machines a/s  
Klokkestøbervej 31  
8800 Viborg  
Denmark  
Phone: +45 87 25 00 15  
info@fshmachines.com  
www.fshmachines.com

### **CE Declaration of Conformity**

We declare under our sole responsibility that this product is in conformity with the following standards or standardization documents: EN60745 according to the provisions of the directives 2004/108/EC, 98/37/EC (until 28 Dec 2009), 2006/42/EC (from 29 Dec 2009).



Finn Skade Hansen  
Managing Director

FSH machines a/s  
Klokkestøbervej 31  
8800 Viborg  
Denmark  
Phone: +45 87 25 00 15  
info@fshmachines.com  
www.fshmachines.com